

OPERATION MANUAL

ZP5008

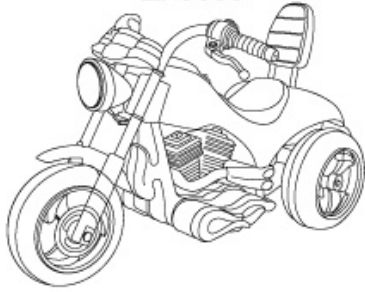

1. THE USE OF INFORMATION

- (1) Before using it for the first time, lift up the seat and connect the main wire to the battery wire (with RED to RED, BLACK to BLACK) any wrong connection may cause short circuit or other faults.
- (2) Put three NO.5 batteries into the battery-case lying under the seat, the end with spring is the negative pole. Make sure to connect the two ends to the right position or it will damage the music board. If long time no use, please take off the batteries.
- (3) Charge the battery 8-10 hours if the vehicle runs slower. Don't charge the battery for over 12 hours each time.
- (4) Charge the battery one time can be used for 1 hour.
- (5) Charge the battery fully if you will store it for a long time, then charge it every 3 month, in this way you can extend the lifetime of the battery.
- (6) It is normal that the power charger and the battery jar become warmer while the battery is on charging.

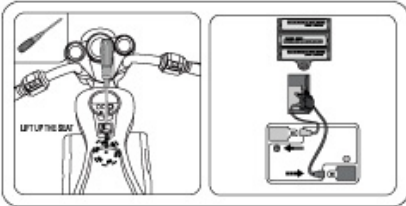

2. Function and Feature

- (1) Forward/Stop/ Backward button: push the button forward to move the vehicle forward, press the stop, the vehicle will be stopped. pull it backward to lead the vehicle backward.
- (2) The vehicle is started by hand. If you need to stop the car, only to loose the switch on the handle, it can be stopped.
- (3) The vehicle has music.

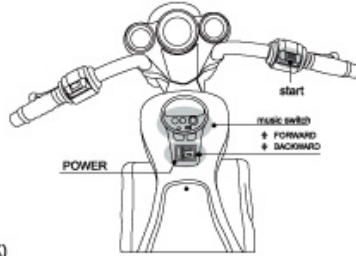

3. Fused tube

When the car cannot move ,please restart in 10 minutes. It maybe caused by the large current and the fuse cutted automatically.

4. Trouble Shooting

Bad Status	Checking points
The vehicle moves slowly.	Check if the battery has been recharged long enough for 8-10hs hours.
The vehicle does not move.	1. Check if the fuse is broken, if so replace it with a good one. 2. Check if the wires are correctly connected.
The battery cannot be fully charged.	1. Check if the fuse is broken, if so, replace it 2. Check if the charger of the battery has been broken.

5. Specification

- (1) Battery: Enclosed lead-acid battery (6V, 10AH) IF IT IS DOUBLE MOTORS & BATTERIES, BATTERY IS 6V/7AH*2
- (2) Loading limitation: 25kg.
- (3) Power: input 220 (110V)
- (4) Duration of the battery: around one hour functioning with 8-12hours charging.
- (5) Size: 115*68*64cm
- (6) User's proper age: suitable for children around 3-8years old

6. WAY TO CHARGE

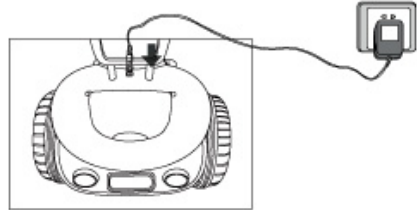

7. Cautions For Safety

- (1) It is prohibited to drive on streets, slopes or any other dangerous places.
- (2) Don't ride on sandy or lumpy surfaces.
- (3) The vehicle is designed to load only one person. Overload is prohibited.
- (5) Adults should do the Battery charging, and don't let the children do it alone.
- (6) It is necessary to be supervised by adults while the child is on riding.
- (7) This product should be assembled or checked before using by adults.
- (7) Don't wash the vehicle with water. Just clean it with cloth.

8. How To Install

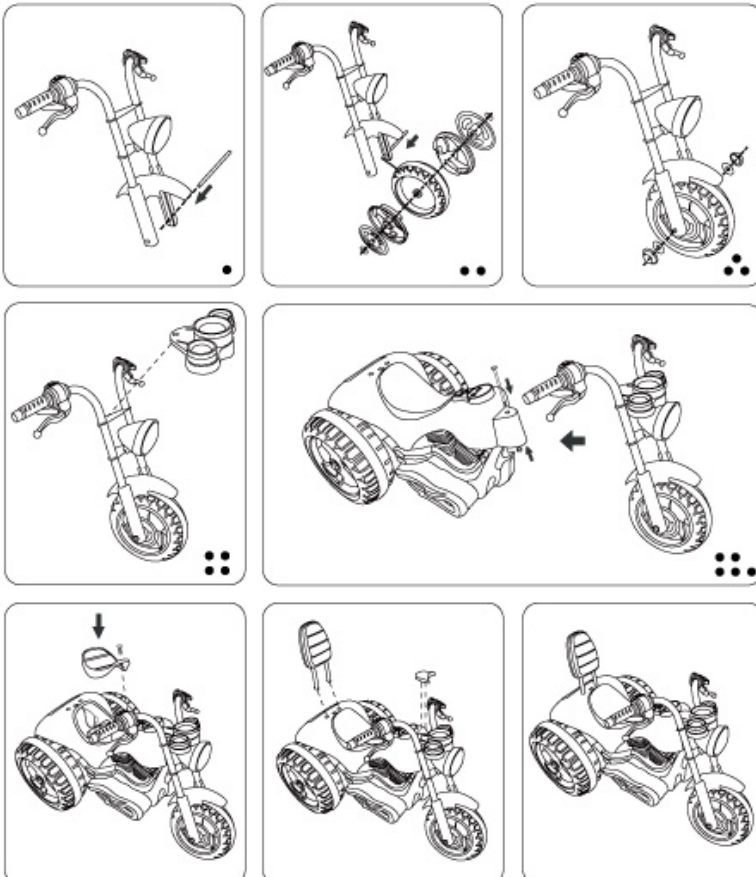

Our products are suitable for ASTM F963, GB6675, EN71 and EN62115 standard.